

Dismantling Joints PN 25

No.	Part Destination	Materials
1	Pipe	Ductile Iron
2	Body	Ductile Iron
3	Retainer	Ductile Iron
4	Ring	Rubber
5	Stud	SS304

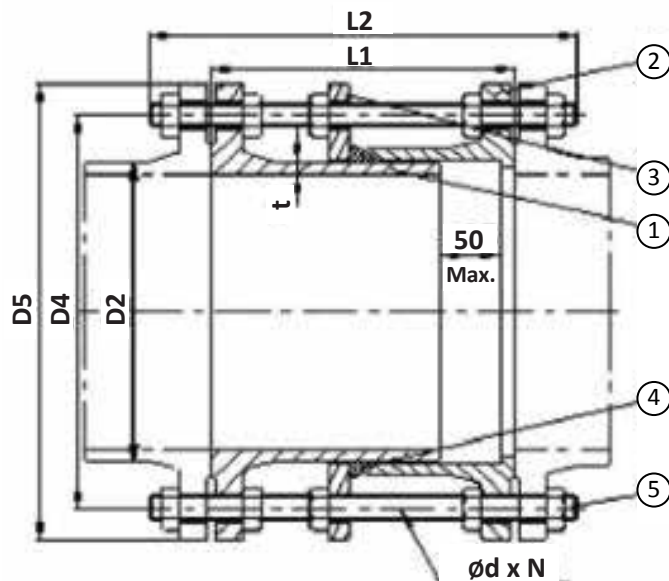

*Flange in accordance with ISO2531 PN25.

**Nominal Pressure: 25 bar, Test Pressure: 25 bar

Size		Main Dimension							
Inch	DN	D2	D4	D5	L1	L2	d(Ø)	N	t
3"	80	98	160	200	210	330	M19	8	7.0
4"	100	118	190	235	220	340	M23	8	7.2
5"	125	144	220	270	220	370	M28	8	7.5
6"	150	170	250	300	230	370	M28	8	7.8
8"	200	222	310	360	230	370	M28	12	8.4
10"	250	274	370	425	250	410	M31	12	9.0
12"	300	326	430	485	250	410	M31	16	9.6
14"	350	378	490	555	270	440	M34	16	10.2
16"	400	429	550	620	280	480	M37	16	10.8
18"	450	480	600	670	280	480	M37	20	11.4
20"	500	532	660	730	300	480	M37	20	12.0
24"	600	635	770	845	320	520	M40	20	13.2
28"	700	738	875	960	340	530	M43	24	14.4
32"	800	842	990	1085	360	600	M49	24	15.6
36"	900	945	1090	1185	380	600	M49	28	16.8
40"	1000	1048	1210	1320	400	650	M56	28	18.0
44"	1100	1152	1310	1420	420	672	M56	32	19.2
48"	1200	1255	1420	1530	450	720	M56	32	20.4
56"	1400	1462	1640	1755	480	770	M62	36	22.8
64"	1600	1668	1860	1975	510	815	M62	40	25.2
72"	1800	1875	2070	2195	540	865	M70	48	27.6
80"	2000	2082	2300	2425	580	930	M70	48	30.0